

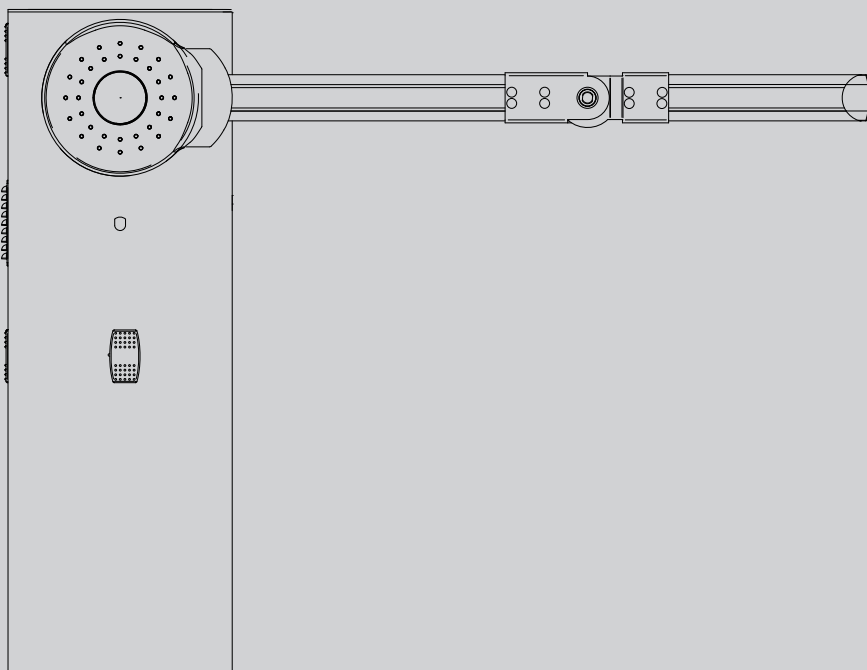

ASTA ARTICOLATA 90°
90° ARTICULATED BOOM
LISSE ARTICULÉE À 90°
90° KNICKBAUM
BARRA ARTICULADA 90°
CHARNIERENDE STAAF 90°

HASTE ARTICULADA A 90°
ΑΡΘΡΩΤΟΣ ΙΣΤΟΣ 90°
DRAŽEK PRZEGUBOWY 90°
ШАРНИРНАЯ ТЯГА 90°
KLOUBOVÝ TYČ 90°
90° MAFSALLI BARİYER KOLU



ART 900 Q

ISTRUZIONI DI INSTALLAZIONE
INSTALLATION MANUAL
INSTRUCTIONS D'INSTALLATION
MONTAGEANLEITUNG
INSTRUCCIONES DE INSTALACION
INSTALLATIEVOORSCHRIFTEN
INSTRUÇÕES DE INSTALAÇÃO
ΟΔΗΓΙΕΣ ΕΓΚΑΤΑΣΤΑΣΗΣ
INSTRUKCJE INSTALACJI
ИНСТРУКЦИИ ПО УСТАНОВКЕ
POKYNY PRO INSTALACI
MONTAJ BILGILERI

BFT





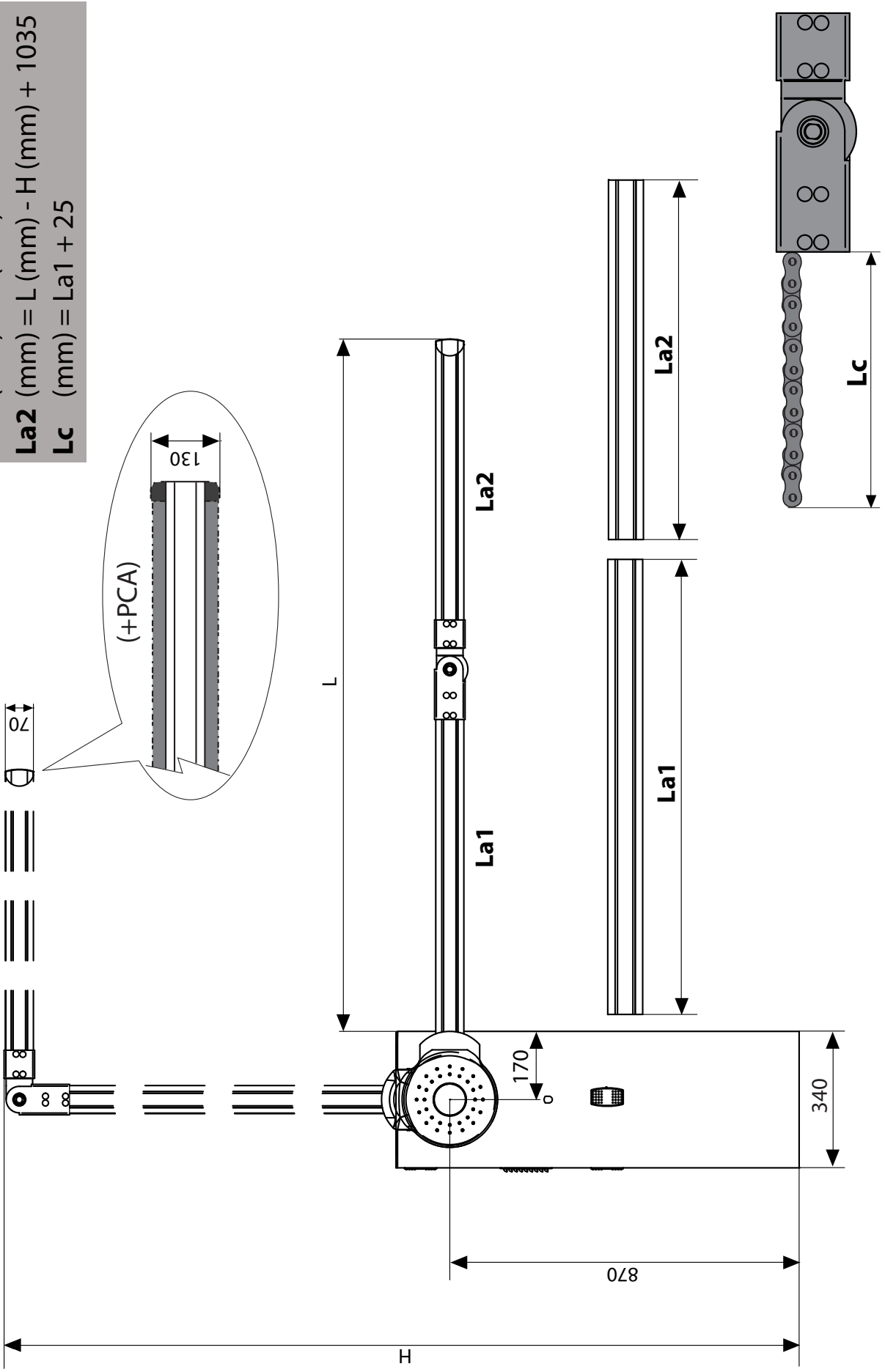

AZIENDA CON SISTEMA DI GESTIONE
INTEGRATO CERTIFICATO DA DNV
= UNI EN ISO 9001:2008 =
UNI EN ISO 14001:2004

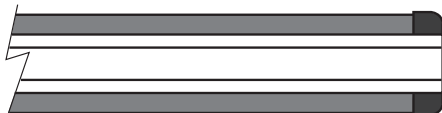
La1 (mm) = H (mm) - 1005
La2 (mm) = L (mm) - H (mm) + 1035
Lc (mm) = La1 + 25



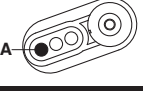



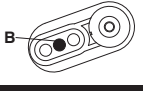
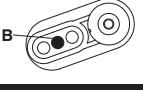
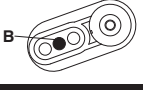
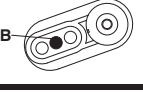
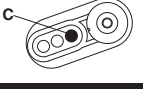
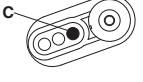

A

H			2000	2100	2200	2300	2400	2500	2600	2700	2800	2900	3000	
MOOVI 60 GIOTTO 60 BT GIOTTO 60 S BT	L 4000 	la1	995	1095	1195	1295	1395	1495	1595	1695	1795	1895	1995	
		la2	3035	2935	2835	2735	2635	2535	2435	2335	2235	2135	2035	
		lc	1020	1120	1220	1320	1420	1520	1620	1720	1820	1920	2020	
	L 3800 	la1	995	1095	1195	1295	1395	1495	1595	1695	1795	1895	1995	
		la2	2835	2735	2635	2535	2435	2335	2235	2135	2035	1935	1835	
		lc	1020	1120	1220	1320	1420	1520	1620	1720	1820	1920	2020	
	L 3600 	la1	995	1095	1195	1295	1395	1495	1595	1695	1795	1895	1995	
		la2	2635	2535	2435	2335	2235	2135	2035	1935	1835	1735	1635	
		lc	1020	1120	1220	1320	1420	1520	1620	1720	1820	1920	2020	
	L 3400 	la1	995	1095	1195	1295	1395	1495	1595	1695	1795	1895	1995	
		la2	2435	2335	2235	2135	2035	1935	1835	1735	1635	1535	1435	
		lc	1020	1120	1220	1320	1420	1520	1620	1720	1820	1920	2020	
	L 3200 	la1	995	1095	1195	1295	1395	1495	1595	1695	1795	1895	1995	
		la2	2235	2135	2035	1935	1835	1735	1635	1535	1435	1335	1235	
		lc	1020	1120	1220	1320	1420	1520	1620	1720	1820	1920	2020	
	MOOVI 30 MOOVI 30S GIOTTO 30 GIOTTO 30 S BT	L 3000 	la1	995	1095	1195	1295	1395	1495	1595	1695	1795	1895	
			la2	2035	1935	1835	1735	1635	1535	1435	1335	1235	1135	
			lc	1020	1120	1220	1320	1420	1520	1620	1720	1820	1920	
L 2800 		la1	995	1095	1195	1295	1395	1495	1595	1695	1795	1895		
		la2	1835	1735	1635	1535	1435	1335	1235	1135	1035	935		
		lc	1020	1120	1220	1320	1420	1520	1620	1720	1820	1920		
L 2600 		la1	995	1095	1195	1295	1395	1495	1595	1695	1795	1895		
		la2	1635	1535	1435	1335	1235	1135	1035	935	835	735		
		lc	1020	1120	1220	1320	1420	1520	1620	1720	1820	1920		
L 2400 		la1	995	1095	1195	1295	1395	1495	1595	1695	1795			
		la2	1435	1335	1235	1135	1035	935	835	735	635			
		lc	1020	1120	1220	1320	1420	1520	1620	1720	1820			
L 2200 		la1	995	1095	1195	1295	1395	1495	1595					
		la2	1235	1135	1035	935	835	735	635					
		lc	1020	1120	1220	1320	1420	1520	1620					
L 2000 		la1	995	1095	1195	1295	1395							
		la2	1035	935	835	735	635							
		lc	1020	1120	1220	1320	1420							

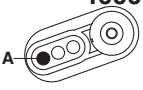
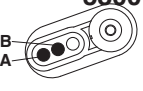
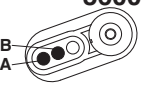
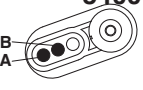

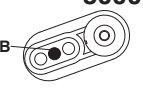
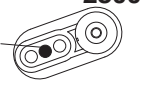
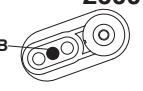
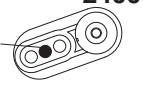
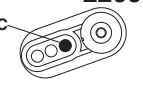
B

H		2000	2100	2200	2300	2400	2500	2600	2700	2800	2900	3000		
MOOVI 60 GIOTTO 60 BT GIOTTO 60 S BT	L 4000 	la1	995	1095	1195	1295	1395	1495	1595	1695	1795	1895	1995	
		la2	3035	2935	2835	2735	2635	2535	2435	2335	2235	2135	2035	
		lc	1020	1120	1220	1320	1420	1520	1620	1720	1820	1920	2020	
	L 3800 	la1	995	1095	1195	1295	1395	1495	1595	1695	1795	1895	1995	
		la2	2835	2735	2635	2535	2435	2335	2235	2135	2035	1935	1835	
		lc	1020	1120	1220	1320	1420	1520	1620	1720	1820	1920	2020	
	L 3600 	la1	995	1095	1195	1295	1395	1495	1595	1695	1795	1895	1995	
		la2	2635	2535	2435	2335	2235	2135	2035	1935	1835	1735	1635	
		lc	1020	1120	1220	1320	1420	1520	1620	1720	1820	1920	2020	
	L 3400 	la1	995	1095	1195	1295	1395	1495	1595	1695	1795	1895	1995	
		la2	2435	2335	2235	2135	2035	1935	1835	1735	1635	1535	1435	
		lc	1020	1120	1220	1320	1420	1520	1620	1720	1820	1920	2020	
	L 3200 	la1	995	1095	1195	1295	1395	1495	1595	1695	1795	1895	1995	
		la2	2235	2135	2035	1935	1835	1735	1635	1535	1435	1335	1235	
		lc	1020	1120	1220	1320	1420	1520	1620	1720	1820	1920	2020	
	MOOVI 30 MOOVI 30S GIOTTO 30 GIOTTO 30 S BT	L 3000 	la1	995	1095	1195	1295	1395	1495	1595	1695	1795	1895	1995
			la2	2035	1935	1835	1735	1635	1535	1435	1335	1235	1135	1035
			lc	1020	1120	1220	1320	1420	1520	1620	1720	1820	1920	2020
L 2800 		la1	995	1095	1195	1295	1395	1495	1595	1695	1795	1895	1995	
		la2	1835	1735	1635	1535	1435	1335	1235	1135	1035	935	835	
		lc	1020	1120	1220	1320	1420	1520	1620	1720	1820	1920	2020	
L 2600 		la1	995	1095	1195	1295	1395	1495	1595	1695	1795	1895	1995	
		la2	1635	1535	1435	1335	1235	1135	1035	935	835	735	635	
		lc	1020	1120	1220	1320	1420	1520	1620	1720	1820	1920	2020	
L 2400 		la1	995	1095	1195	1295	1395	1495	1595	1695	1795	1895		
		la2	1435	1335	1235	1135	1035	935	835	735	635	535		
		lc	1020	1120	1220	1320	1420	1520	1620	1720	1820	1920		
L 2200 		la1	995	1095	1195	1295	1395	1495	1595	1695				
		la2	1235	1135	1035	935	835	735	635	535				
		lc	1020	1120	1220	1320	1420	1520	1620	1720				
L 2000 		la1	995	1095	1195	1295	1395	1495						
		la2	1035	935	835	735	635	535						
		lc	1020	1120	1220	1320	1420	1520						

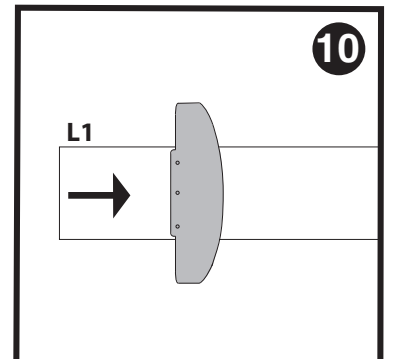
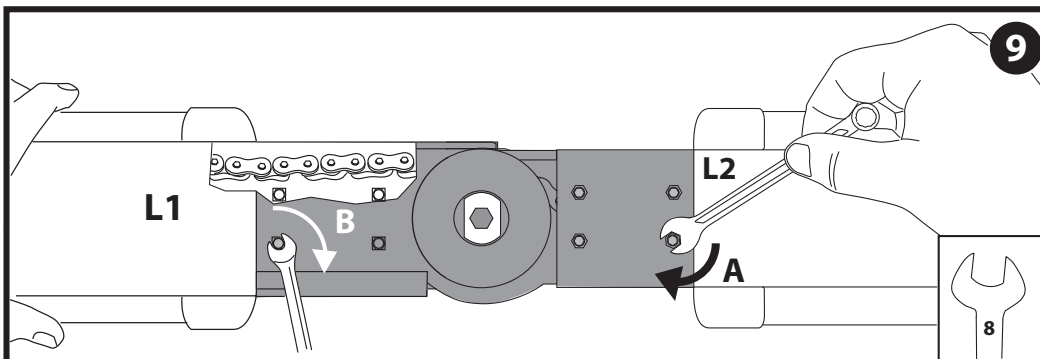
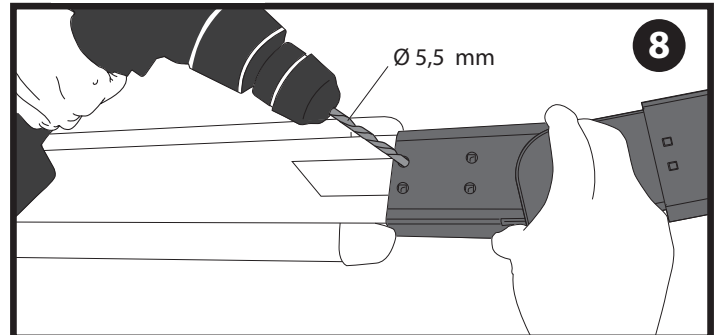
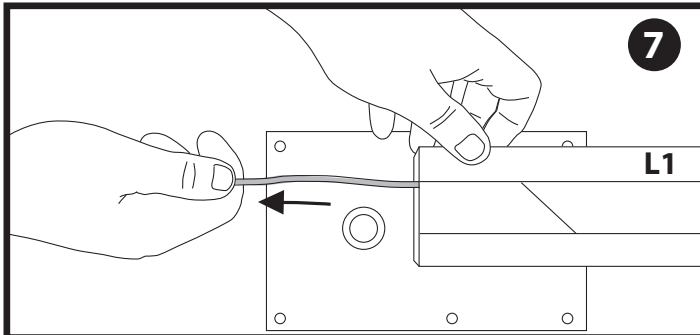
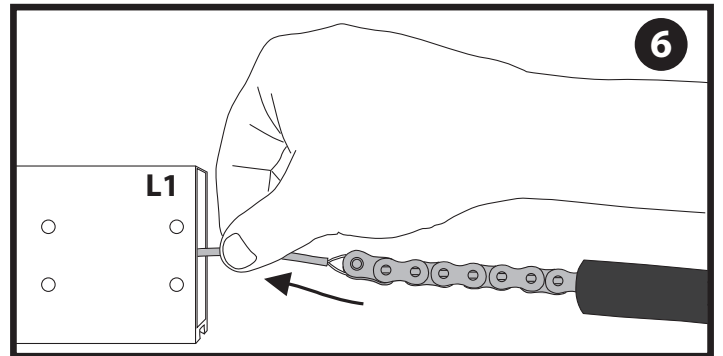
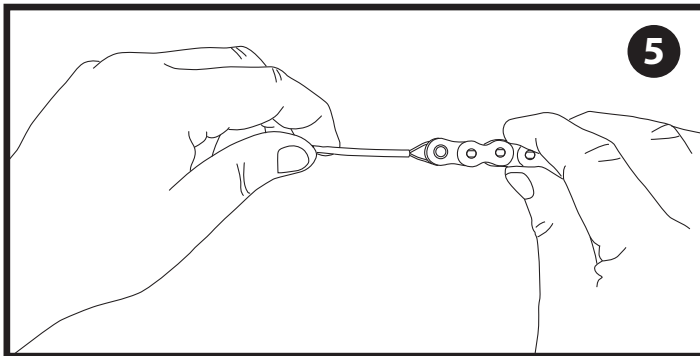
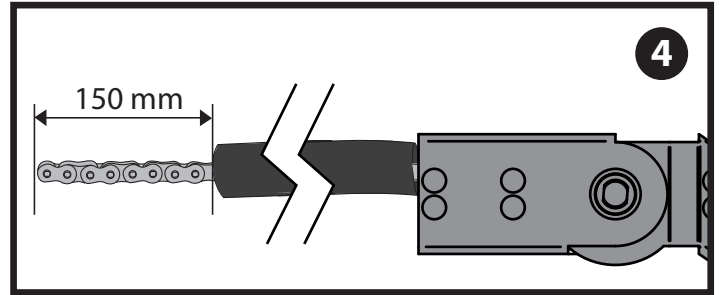
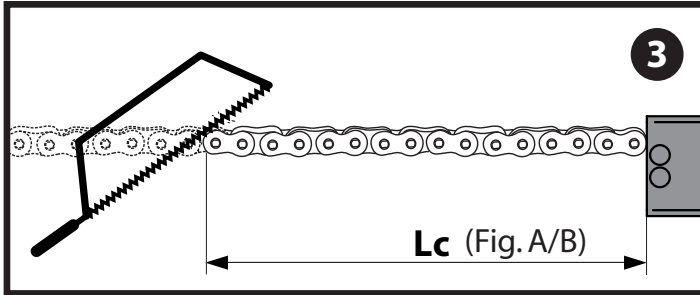
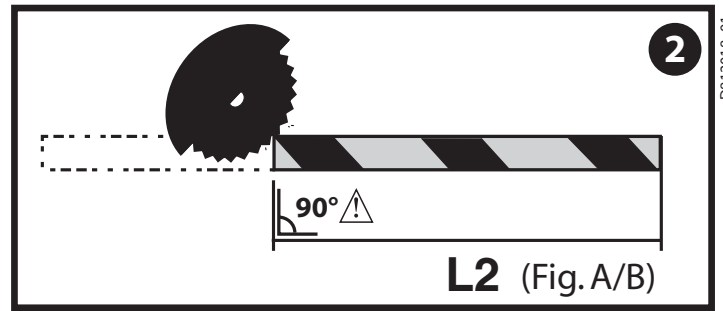
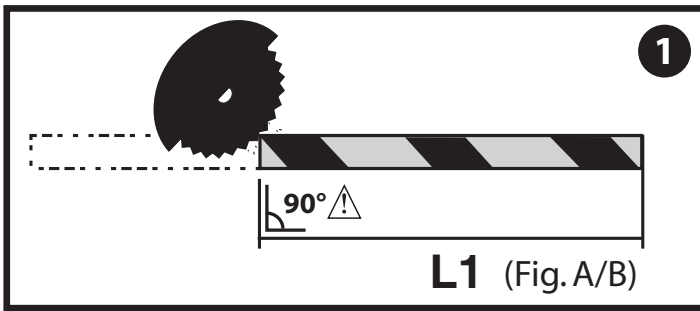

Fissare la finta maglia nel punto A. Nel caso la catena risulti troppo lunga o corta fissare nel punto B o C.
 Fasten the chain at point A. If the chain proves too long or short, fasten at point B or C.
 Fixez la chaîne en A. Si la chaîne est trop longue ou trop courte, fixez-la en B ou en C.
 Befestigen Sie die Kette an Punkt A. Befestigen Sie sie an Punkt B oder C, falls sie zu lang oder zu kurz ist.
 Fijar la cadena en el punto A. En el caso que la cadena fuera demasiado larga o corta, fijarla en el punto B o C.
 De ketting in punt A bevestigen. Mocht de ketting te lang of te kort zijn, in punt B of C bevestigen.
 Fixar a correia no ponto A. Se a correia estiver demasiado comprida ou curta deve-se fixá-la no ponto B ou C.
 Στερεώστε την αλυσίδα στο σημείο Α. Σε περίπτωση που η αλυσίδα είναι πολύ μακριά ή κοντή στερεώστε στο σημείο Β ή C.
 Zamocować łańcuch w punkcie A. Jeżeli łańcuch okaże się za długi lub za krótki, zamocować go w punkcie B lub C.
 Закрепите цепь в точке А. В случае, если цепь окажется слишком длинной или короткой, закрепите в точке В или С.
 Řetěz připevněte v bodě A. Pokud je řetěz příliš dlouhý nebo krátký, připevněte jej v bodě B nebo C.
 Zinciri A noktasına sabitleyin. Zincirin a?ırı uzun veya a?ırı kısa olması halinde, B veya C noktasına sabitleyin.

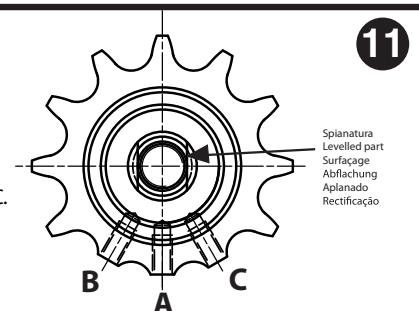

Se necessario, aggiungere alla catena la finta maglia in dotazione.
 If necessary, add the master link provided to the chain.
 Si nécessaire, ajouter à la chaîne le faux maillon fourni.
 Falls erforderlich das mitgelieferte Blindglied der Kette hinzufügen.
 Si es necesario, agregar a la cadena el falso eslabón suministrado con el equipamiento.
 Indien noodzakelijk, de meegeleverde nepschakel aan de ketting toevoegen.
 Se for necessário, Juntar o falso elo, fornecido com o equipamento, à corrente.
 En ανάγκη, προσθέστε στην αλυσίδα τον ψεύτικο κρίκο που διατίθεται.
 Jeśli potrzeba, dodać na łańcuch sztuczne ogniwo, które znajduje się w zestawie.
 При необходимости, присоедините к цепи холостое звено, поставляемое в комплекте.
 Pokud je to nutné, přidejte k řetězu falešný článek z výbary.
 Gerekmesi halinde, tedarik dahilinde bulunan sahte baklayı zincire ilave edin.

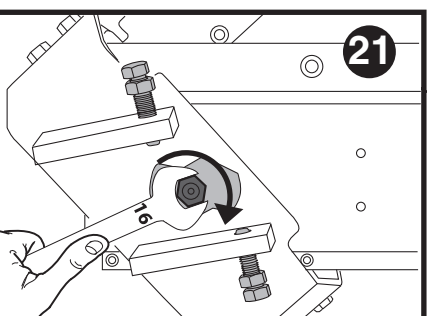
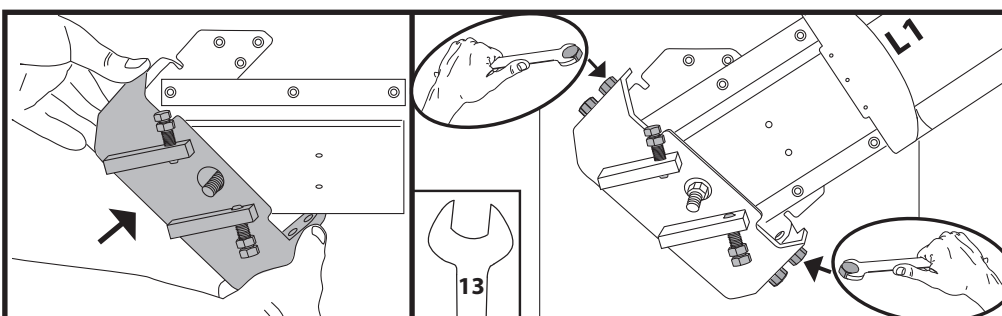
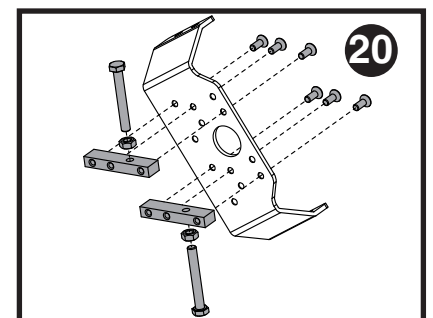
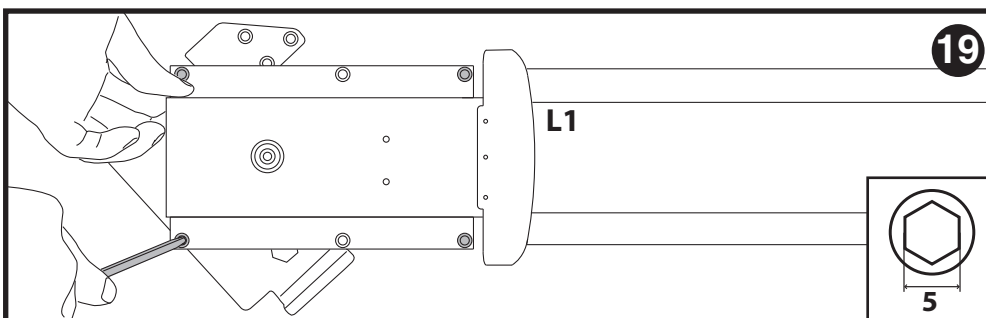
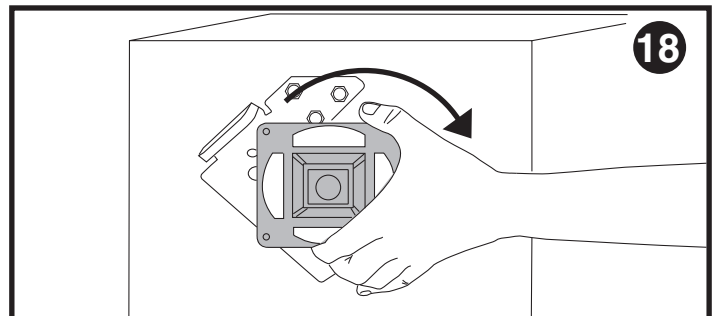
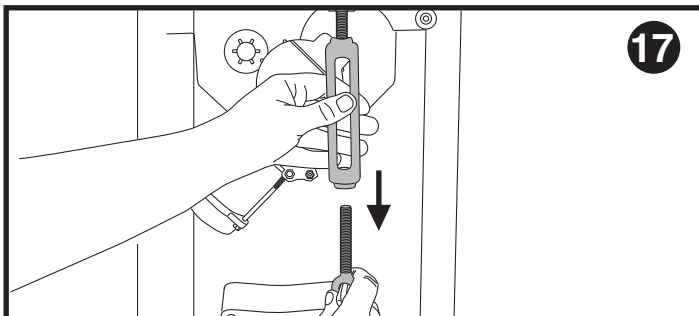
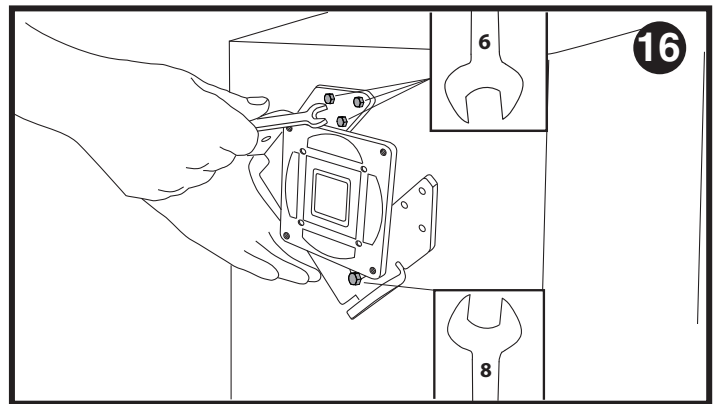
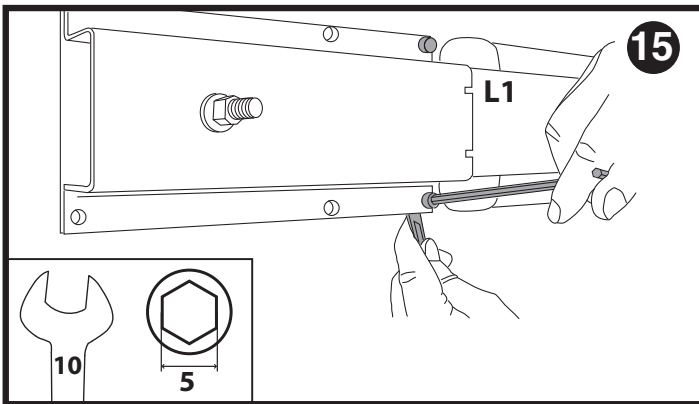
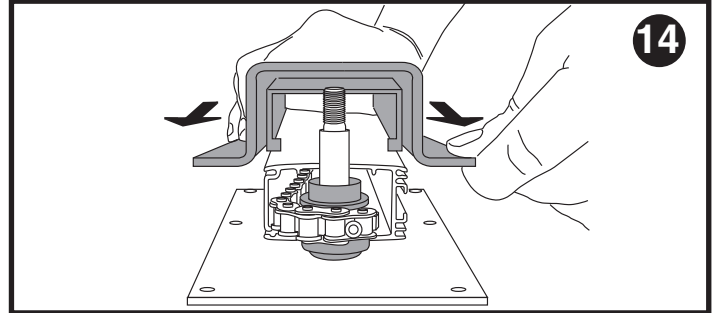
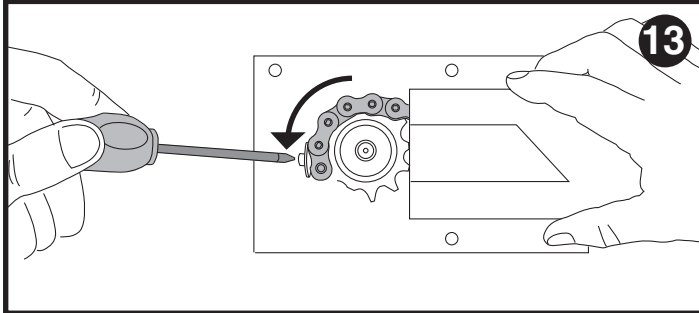
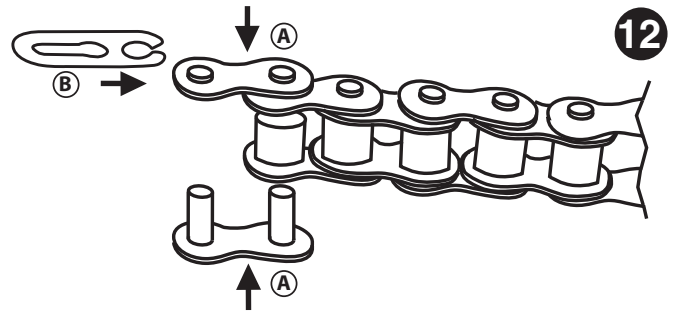

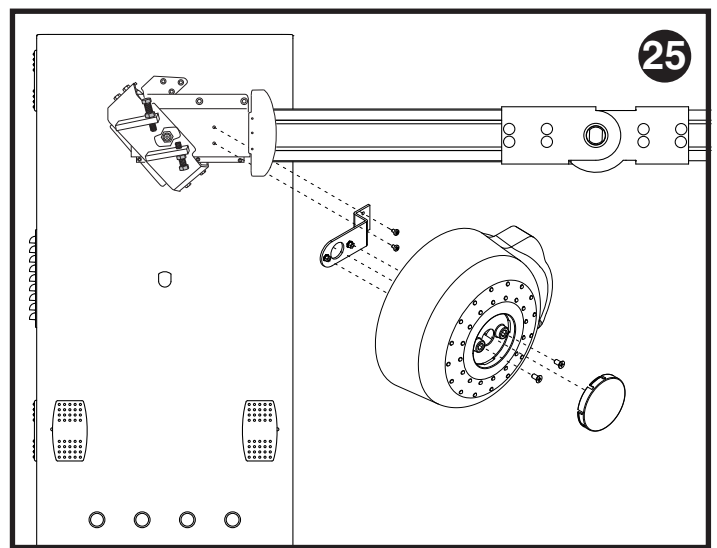
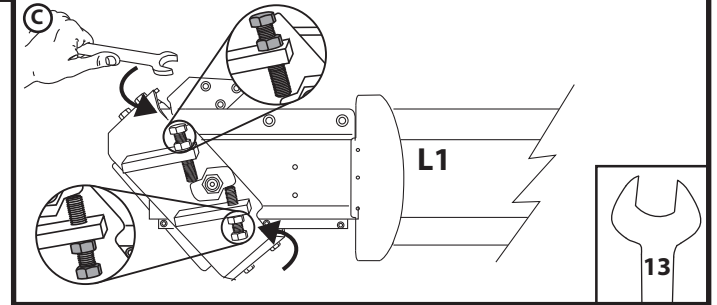
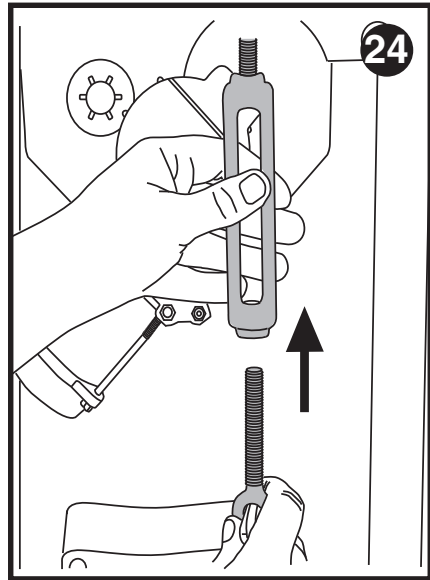
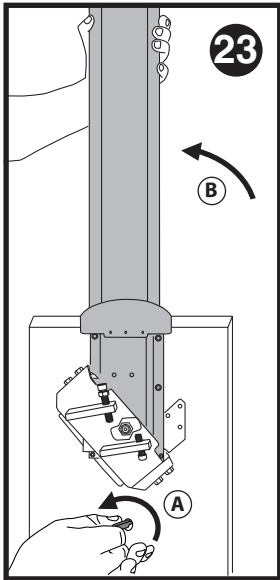
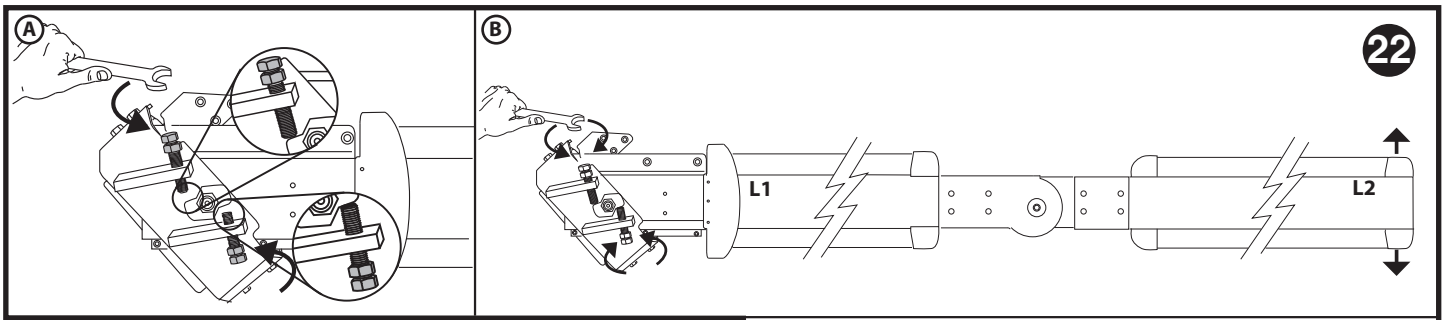

Installazione ESCLUSIVAMENTE per asta SINISTRA - Installation for LEFT arm ONLY - Installation EXCLUSIVEMENT pour barre GAUCHE - Installation AUSCHLIESSLICH für den LINKEN Stab - Instalación EXCLUSIVAMENTE para mástil IZQUIERDO - Installatie UITSLUITEND voor LINKERstang - Instalação EXCLUSIVAMENTE para haste ESQUERDA - Εγκατάσταση ΑΠΟΚΛΕΙΣΤΙΚΑ για ΑΡΙΣΤΕΡΟ ιστό - Instalacja WYŁĄCZNIK dla LEWEGO drążka - Установка ИСКЛЮЧИТЕЛЬНО для левого СТЕРЖНЯ - Instalace VÝLUČNĚ pro LEVOU tyč - SADECE SOL bariyer kolu için montaj

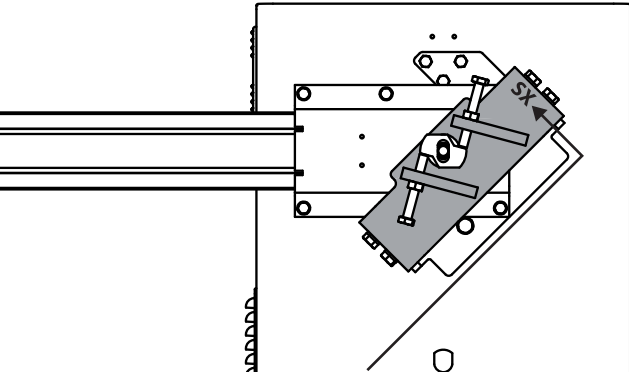

La piastra è segnata con il riferimento SX.
The plate is marked with SX reference.
La plaque est indiquée par la référence SX (Gauche).
Die Platte ist mit SX gekennzeichnet.
La placa está indicada con la referencia SX.
De plaat is gemarkeerd met de referentie SX.
A chapa está marcada com a referência SX.
Η πλάκα φέρει την ένδειξη SX (αριστερά).
Płyta jest oznaczona znakiem SX.
Пластина помечена ноской SX (установка слева).
Deska je označena značkou SX (levá).
Plaka, SX referansı ile işaretlenmiştir.

Montaggio Sinistro, Left-hand fitting, Montage à gauche, Linkseitiger Aufbau, Montaje izquierdo, Montage links, Montagem esquerda, Αριστερή τοποθέτηση, Montaż z lewej strony, Монтаж с левой стороны, Levostranná montáž, Sol montaj.

Montaggio Destro, Right-hand fitting, Montage droit, Rechtsseitiger Aufbau, Montaje derecho, Montage rechts, Montagem direita, Δεξιά τοποθέτηση, Montaż z prawej strony, Монтаж с правой стороны, Pravostranná montáž, Sağ montaj.

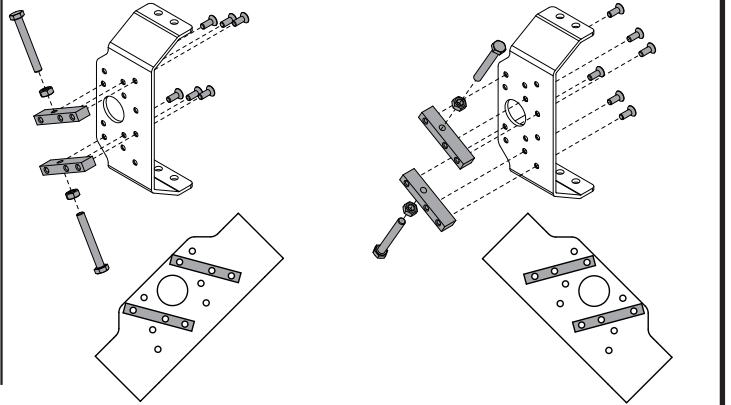

Bft Spa
Via Lago di Vico, 44
36015 Schio (VI)
T +39 0445 69 65 11
F +39 0445 69 65 22
→ www.bft.it

SPAIN
BFT GROUP ITALIBERICA DE AUTOMATISMOS S.L.
08401 Granollers - (Barcelona)
www.bftautomatismos.com

FRANCE
AUTOMATISMES BFT FRANCE
69800 Saint Priest
www.bft-france.com

GERMANY
BFT TORANTRIEBSSYSTEME GmbH
90522 Oberasbach
www.bft-torantriebe.de

UNITED KINGDOM
BFT AUTOMATION UK LTD
Stockport, Cheshire, SK7 5DA
www.bft.co.uk

IRELAND
BFT AUTOMATION LTD
Dublin 12

BENELUX
BFT BENELUX SA
1400 Nivelles
www.bftbenelux.be

POLAND
BFT POLSKA SP. Z O.O.
05-091 ZABKI
www.bft.pl

CROATIA
BFT ADRIA D.O.O.
51218 Drazice (Rijeka)
www.bft.hr

PORTUGAL
BFT SA-COMERCIO DE AUTOMATISMOS E MATERIAL DE SEGURANCIA
3020-305 Coimbra
www.bftportugal.com

CZECH REPUBLIC
BFT CZ S.R.O.
Praha
www.bft.it

TURKEY
BFT OTOMATIK KAPI SISTEMELERI SANAY VE
Istanbul
www.bftotomasyon.com.tr

RUSSIA
BFT RUSSIA
111020 Moscow
www.bft.rus.ru

AUSTRALIA
BFT AUTOMATION AUSTRALIA PTY LTD
Wetherill Park (Sydney)
www.bftaustralia.com.au

U.S.A.
BFT USA
Boca Raton
www.bft-usa.com

CHINA
BFT CHINA
Shanghai 200072
www.bft-china.cn

UAE
BFT Middle East FZCO
Dubai

